

LM2X-DMHP-RGB 3-Color LED Light Source

(Product ID: LM2X-DMHP-RGB)

The LM2X-DMHP-RGB is a 2-inch, air-cooled LED light source that provides three-color (Red, Green, and Blue) outputs. This LED is used for Particle Shadow Velocimetry (PSV) to illuminate small seed particles in a flow field to measure velocity and particle density. The LM2X-DMHP-RGB has three BNC inputs to control the timing and pulse width of each of the output colors from an external pulse generator. The pulsed LED operation is controlled by applying a TTL voltage to the external BNC(s) on the module. The rise time is less than 200-ns and the fall time is less than 100-ns and the duty cycle is 5%. The light distribution from the unit is approximately Gaussian for distance greater than 18 inches from the source.



Ordering information: LM2X-DMHP-RGB (LED head with short-pulse/high-power driver)

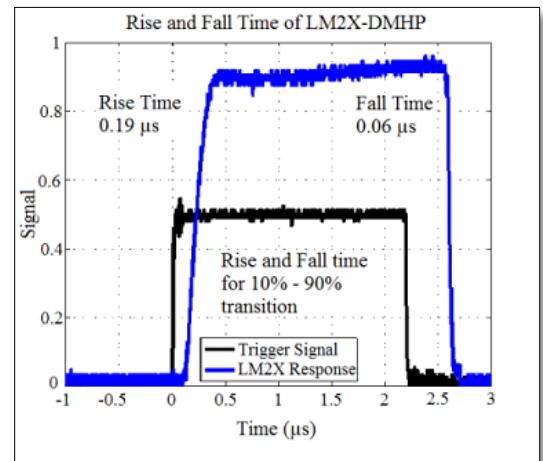
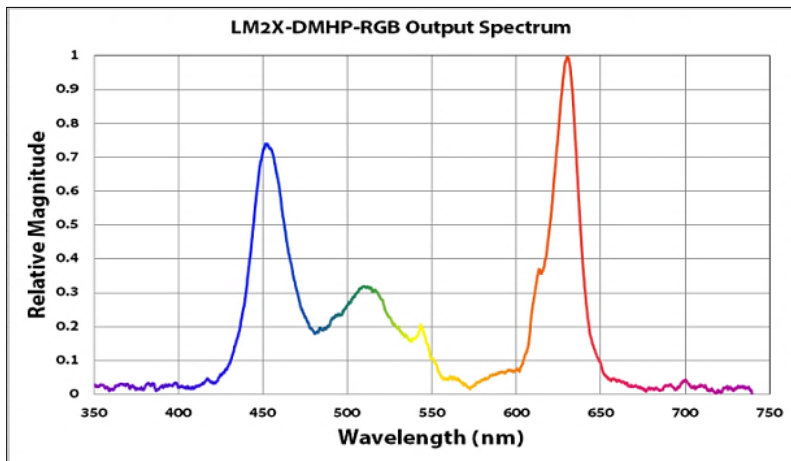

SPECIFICATIONS

Optical Power	~2 W
Input	48V --- 2.7A
Stability	~0.1 % per hour after warmup
Wavelength	460-nm, 520-nm, 630-nm
Rise time (10% - 90%)	< 200 ns
Fall time (90% - 10%)	< 100 ns
Maximum Duty Cycle	5%
Operating Temperature	-10°C to 60°C
FWHM	+/- 18-nm
ECCN	EAR99

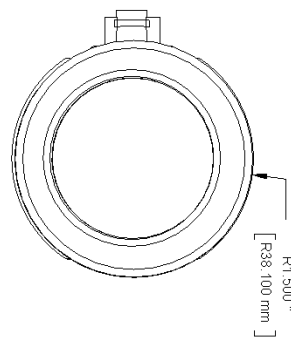
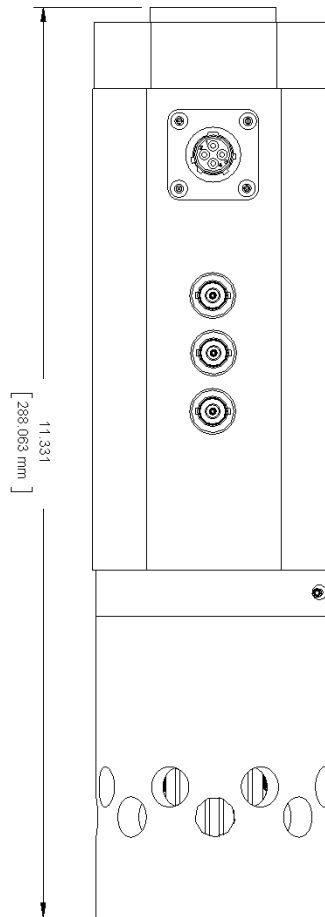

LM2X-DMHP-RGB